



ETC® Setup Guide

Unison Paradigm® Docking Station

Overview

The Unison Paradigm® Docking Station (P-LCD-DOCK) connects to the Paradigm lighting control network using NetConnect and serves the Paradigm Handheld Touchscreen as both a charging station and as a wireless interface for MeshConnect communications.

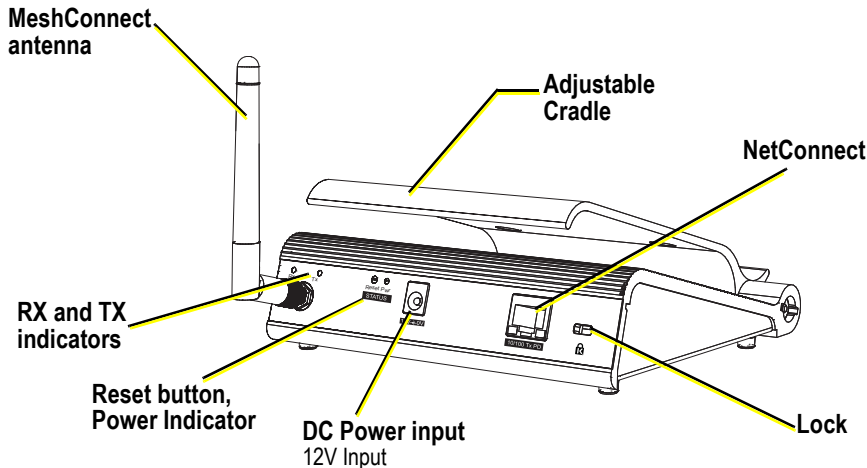

Buttons and Indicators

- RX and TX indicators - flashes when the Docking Station sends (TX) or receives (RX) a wireless communication.
- Reset button - when pressed resets the Docking Station. After reboot, any Handheld that is connected to the Docking Station will reload the configuration.
- Power indicator - illuminates solid when power is connected.

NetConnect

NetConnect uses Power over Ethernet (IEEE 802.3af) communications to connect between the Paradigm Docking Station and the Paradigm Architectural Control Processor (P-ACP).

A 12V DC power input adapter is supplied and can be used when Power over Ethernet is not available.

MeshConnect

MeshConnect is the wireless control network used with the Paradigm Handheld Touchscreen for communication with a Docking Station and/or Wireless Access Station.



Note:

This device complies with part 15 of the FCC Rules. Operation is subject to the following two conditions: (1) This device may not cause harmful interference, and (2) this device must accept any interference received, including interference that may cause undesired operation.

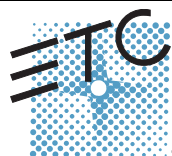

Corporate Headquarters ■ 3031 Pleasant View Road, P.O. Box 620979, Middleton, Wisconsin 53562-0979 USA ■ Tel +608 831 4116 ■ Fax +608 836 1736
London, UK ■ Unit 26-28, Victoria Industrial Estate, Victoria Road, London W3 6UU, UK ■ Tel +44 (0)20 8896 1000 ■ Fax +44 (0)20 8896 2000
Rome, IT ■ Via Pieve Torina, 48, 00156 Rome, Italy ■ Tel +39 (06) 32 111 683 ■ Fax +44 (0) 20 8752 8486
Holzkirchen, DE ■ Ohmstrasse 3, 83607 Holzkirchen, Germany ■ Tel +49 (80 24) 47 00-0 ■ Fax +49 (80 24) 47 00-3 00
Hong Kong ■ Rm 1801, 18/F, Tower 1 Phase 1, Enterprise Square, 9 Sheung Yuet Road, Kowloon Bay, Kowloon, Hong Kong ■ Tel +852 2799 1220 ■ Fax +852 2799 9325
Service: (Americas) service@etconnect.com ■ (UK) service@etceurope.com ■ (DE) techserv-hoki@etconnect.com ■ (Asia) service@etcasia.com
Web: www.etconnect.com ■ Copyright © 2013 ETC. All Rights Reserved. ■ Product information and specifications subject to change.
7184M2240 ■ Rev A ■ Released 2013-10 ■ ETC intends this document to be provided in its entirety.

Setup the Docking Station

The Paradigm Docking Station is intended for use on a flat surface, where wireless communication is optimal and where it is most convenient for use as a charging station. For added security, a Kensington lock receptacle is provided on the rear panel of the Docking Station.

Supply Power and Data to the Docking Station

Determine how you will supply power and data to the Docking Station.

Power over Ethernet (IEEE 802.3af)

Power over Ethernet supplies both data and power to the Docking Station. When using PoE, connect the provided Ethernet patch cable between the Ethernet receptacle on the Docking Station and the wall plate connected to a PoE compatible switch on the lighting control network.

12V Power Supply and Ethernet Data

When using the provided power supply to power the Docking Station, connect the provided cable between the 12V receptacle on the Docking Station and the power source.

For data, connect the provided Ethernet patch cable between the Ethernet receptacle on the Docking Station and a network switch on the lighting control network.



Note: *All Ethernet connections must follow IEEE 802.3 requirements and be terminated to the T568B standard.*

Configure the Docking Station

As part of the process of connecting and configuring a Docking Station using MeshConnect, the following **system requirements** must be met:

- All components used, including the Handheld Touchscreens, Docking Stations, and Wireless Access Stations must exist and be properly configured in the system configuration.
- The Docking Station must be assigned a compatible IP Address. IP Address configuration is accomplished with a Handheld Touchscreen docked to the Docking Station. Reference See [“Assign the Docking Station IP Address”](#) on page 3.
- The Wireless HF Channel property for the Docking Station matches the HF Channel on the Handheld Touchscreen. This setting by factory default is HF Channel 10. To configure the HF Channel for the Docking Station, reference the *Paradigm Architectural Control Processor Configuration Manual*.

Docking a Handheld to the Docking Station

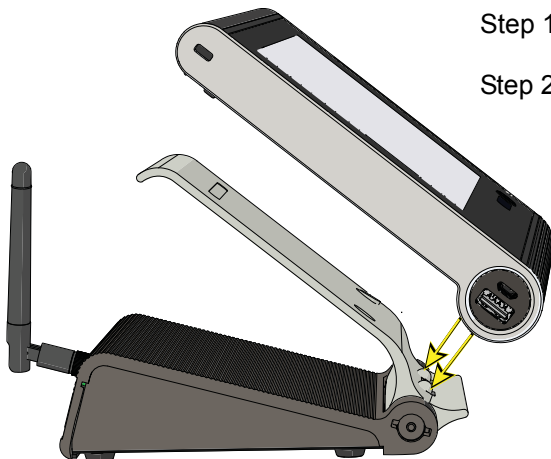

Step 1: Align the Handheld Touchscreen with the Docking Station cradle alignment pins.

Step 2: Rest the Touchscreen in the cradle. A docked icon displays in the bottom left corner of the Touchscreen when it has been properly docked.

Assign the Docking Station IP Address

Step 1: Power on the Handheld Touchscreen and dock it to the Docking Station.

Step 2: Press the **[Setup]** button on the Touchscreen. The Setup “About” screen displays.

Step 3: Press the **[Dock]** tab. The passcode keypad displays.

Step 4: Enter the setup or admin passcode. By factory default, the setup passcode is set to 3031. The “Dock” configuration page displays.

Step 5: The Dock configuration page provides two IP Addressing modes for use with the Docking Station; Manual and Automatic.

- **Manual** - in manual address mode, the IP address and settings are user configured. To change any portion of the address, simply touch inside the field you wish to modify. A numeric keypad displays for edit of the selected field. Make the modifications to the selected field then select other fields as necessary. Pressing **[OK]** will save any changes and exit the *Setup Menu*. If a configuration is active, you will be returned to the configuration.
- **Automatic** - in automatic address mode, the IP address and other network settings will be automatically assigned by a connected DHCP server. The Handheld Touchscreen will display the Docking Stations current settings; the settings are not editable. Pressing **[OK]** will save any changes and exit the Setup Menu. If a configuration is active, you will be returned to the configuration.

Configure the Docking Station HF Channel

The Docking Station must be assigned to the same HF Channel as the Handheld Touchscreen for communication over MeshConnect. Configure the HF Channel for the Docking Station from the connected Paradigm Architectural Control Processor (P-ACP).

Detailed instructions are available in the Paradigm Architectural Control Processor Configuration Manual.

Step 1: Navigate to the Arch Setup > Lonworks Connections menu.

Step 2: Select Wireless HF Channel.

Step 3: Select the Docking Station from the list for configuration.

Step 4: Select the desired HF Channel. Available settings are HF Channel 1 through HF Channel 12.



Note:

All wireless devices that are intended to communicate with each other must be set to the same HF Channel. This includes Handheld Touchscreens when docked to Docking Stations.
